

# PUBLIC MEETING

## DAKOTA COUNTY RURAL WATER SERVICE EXPANSION



**PAPIO-MISSOURI RIVER  
NATURAL RESOURCES DISTRICT**

*Finding Solutions Today for a Secure Tomorrow.*

# HISTORY OF DAKOTA COUNTY

## RURAL WATER SYSTEM



Began operation  
in 1980



System provides  
water service to over  
660+ households



Water is purchased  
from Dakota City  
and conveyed through  
a network of 100+ miles  
of water mains



Key Infrastructure:  
300k gallon elevated  
water tower, 25k gallon  
standpipe and booster  
pump station



PAPIO-MISSOURI RIVER  
NATURAL RESOURCES DISTRICT  
*Finding Solutions Today for a Secure Tomorrow.*

# PHASE 1

## UPGRADE BOOSTER PUMP AND STANDPIPE

In order to serve the Kramper Lake - Danish Alps Recreation Area or additional residents along Fiddler Creek Road, the current booster pump and standpipe will need to be upgraded.

Upgrades would include:

- Increase standpipe to 75,000-100,000 gal.
- Constructing larger above ground booster pump station

## UPGRADE WATER MAIN THAT FEEDS THE BOOSTER PUMP STATION

In order to keep up with the pump capacity of the new booster pump station, the water main that feeds the booster pump station would need to be upgraded from a 4" to 6" diameter water main (this upgrade is only needed if Hubbard connects).





# PHASE 2

## EXTEND RURAL WATER TO FIDDLE CREEK ROAD

In order to serve residents along Fiddler Creek Road, a 4" water main would need to be extended south along M Avenue and run back east of Fiddler Creek Road to create a loop.

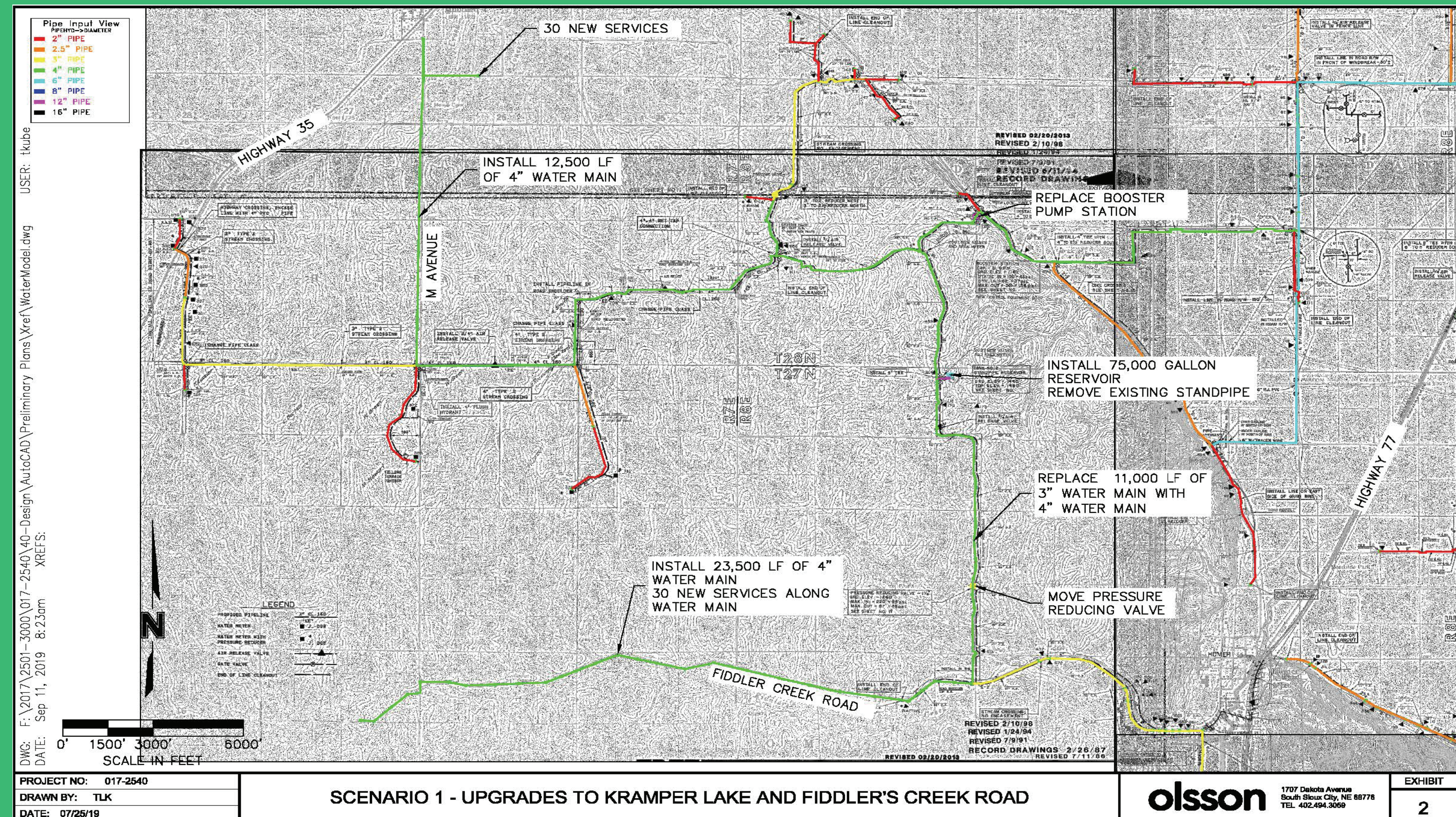

**PAPIO-MISSOURI RIVER  
NATURAL RESOURCES DISTRICT**  
Finding Solutions Today for a Secure Tomorrow.



# PHASE 3

## EXTEND RURAL WATER TO THE VILLAGE OF HUBBARD

In recent years, there has been a shift to regionalize smaller water systems to take advantage of economies of scale and to stay ahead of increasing regulation.

The Village of Hubbard is located just west of the Kramper Lake – Danish Alps Recreation Area and would be connected to the new water main that serves the rec area.

The 6" water line upgrades are only necessary if Hubbard connects.

Connecting to Dakota County Rural Water would likely be the least cost alternative for Hubbard in the future.

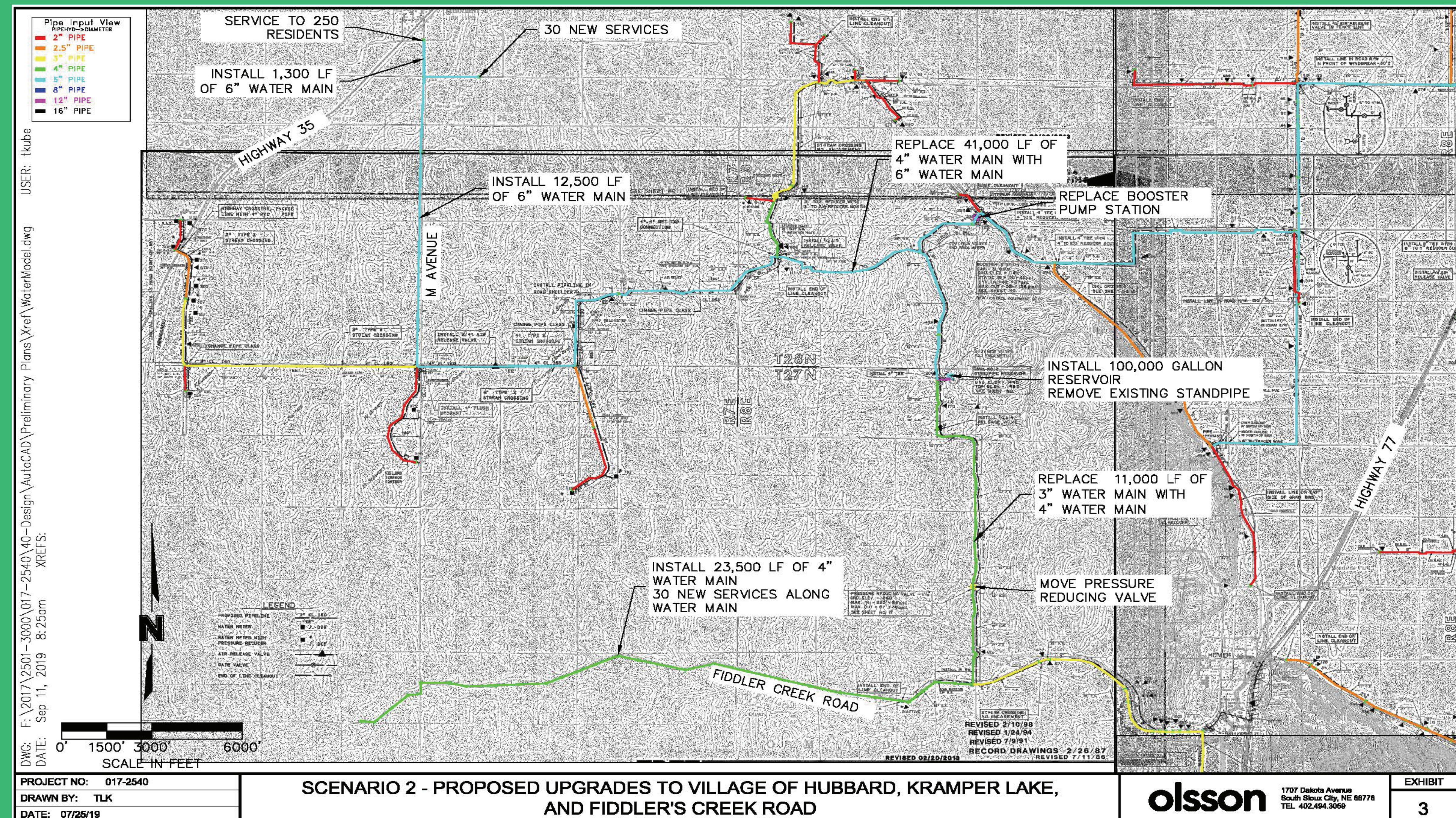



# PHASING OPTIONS



Phased upgrades allow for budget planning



Different funding resources could be used on each phase



Phasing separates O/M projects from system upgrades due to new demand

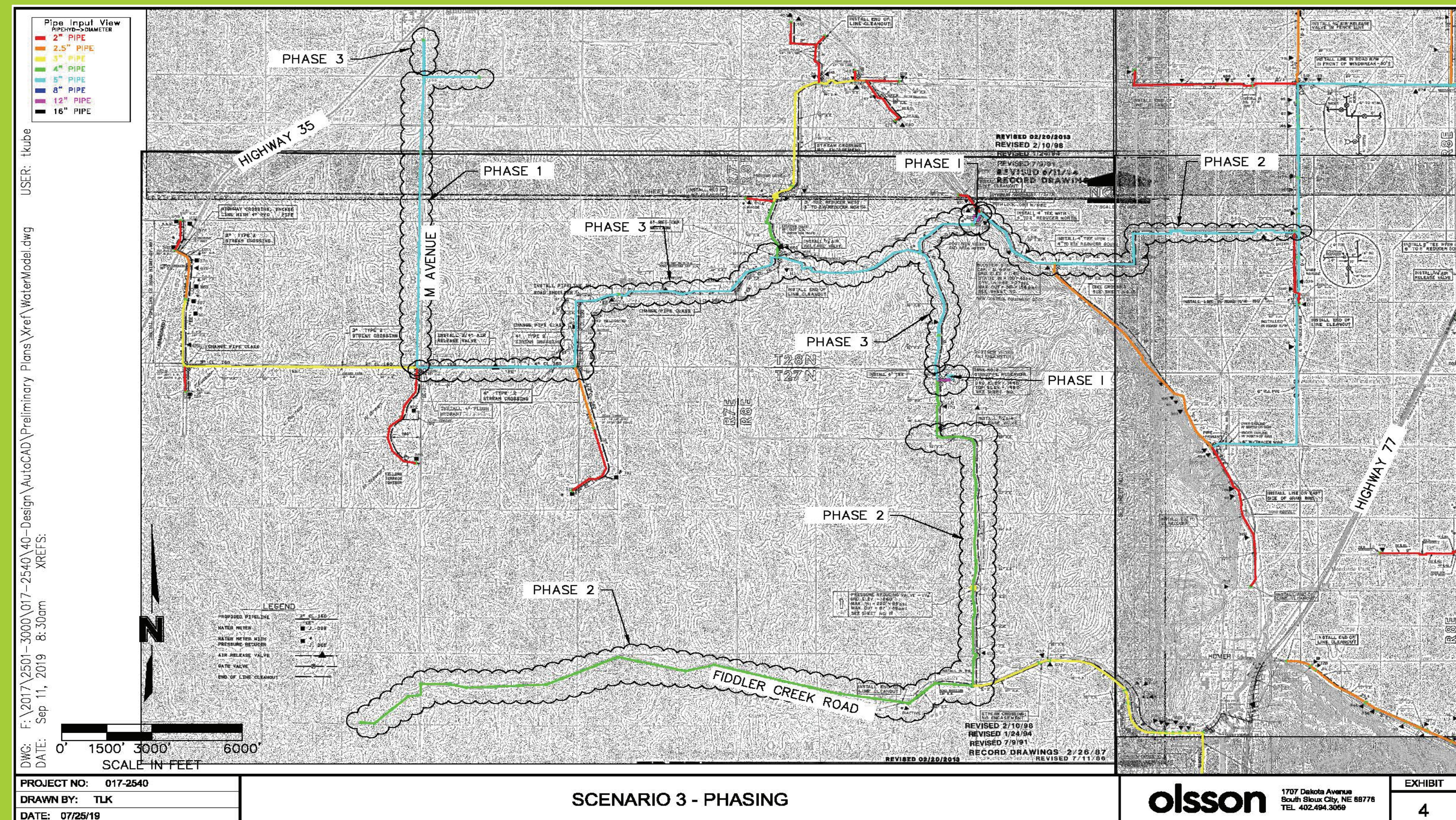

**PAPIO-MISSOURI RIVER  
NATURAL RESOURCES DISTRICT**  
Finding Solutions Today for a Secure Tomorrow.